



433 Council Drive, Fort Wayne, IN 46825

By Order of Secured Creditor:

MILLENNIUM MOLD & ENGINEERING

Sale Location: 11654 East 400 South LaOtto, Indiana 46763

TUESDAY, MARCH 31st Beginning @ 12 Noon Local Time

Preview Inspection: Monday, March 31st 8:00 a.m. - 12:00 Noon

MARCH						
SUN	MON	TUE	WED	THU	FRI	SAT
1	2	3	4	5	6	7
8	9	10	11	12	13	14
15	16	17	18	19	22	21
22	23	24	25	26	27	28
29	30	31				

FREE LISTINGS!

Grand Reopening of the "NEW" Charleston Equipment Marketplace.

Major Manufacturers Under Contract to Upload Equipment Daily.

Please visit: www.CharlestonAuctions.com for more information!

FIRST CLASS
U.S. POSTAGE
PAID
FORT WAYNE, IN
PERMIT #1420

AUCTION

MILLENNIUM MOLD & ENGINEERING

By Order of Secured Creditor:
Millennium Mold & Engineering

11654 EAST 400 SOUTH LAOTTO, IN 46763

TUESDAY, MARCH 31st – BEGINNING @ 12 NOON LOCAL TIME



VICTOR TOOL ROOM LATHE



HYSTER 8,000 LB. LP FORK TRUCK



(1 of 8) VARIOUS PLASTIC INJECTION PRESSES

REAL ESTATE TO BE SOLD @ 12:00 NOON



2001 GMC ENVOY SLT

WWW.CHARLESTONAUCTIONS.COM

AUCTION

MILLENNIUM MOLD & ENGINEERING

Sale Date: Tuesday, March 31st Beginning @ 12 Noon Local Time

MILLENNIUM MOLD & ENGINEERING

11654 East 400 South, Laotto, IN 46763

By Order of Secured Creditor:

MAP

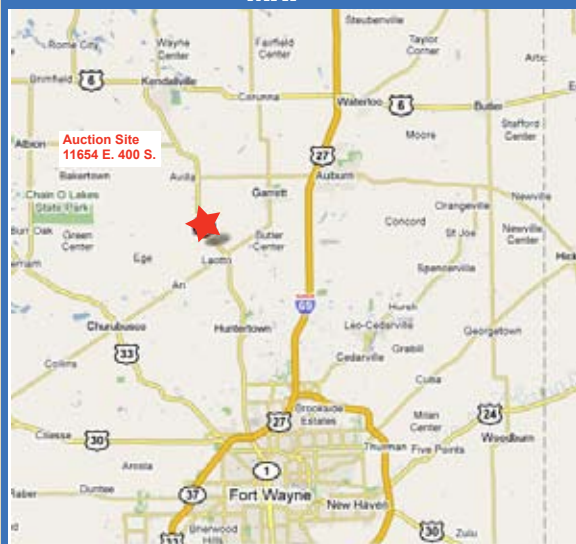

DRIVING DIRECTIONS

FROM CHARLESTON AUCTIONS

1. Head west on Council Dr toward Merchandise Dr 0.1 mi
 2. Turn left at Merchandise Dr 0.2 mi
 3. Turn left to stay on Merchandise Dr 325 ft
 4. Turn right at Ley Rd 348 ft
 5. Turn right at IN-1/Lima Rd/US-27 - Continue to follow Lima Rd 6.4 mi
 6. Continue on IN-3/State Rd 3 6.0 mi
 7. Turn left at 62nd Rd 0.2 mi
 8. Continue on E 400 S 0.3 mi
 9. Turn left at S Old State Rd 3 171 ft
 10. Turn right at E 400 S 0.8 mi
- END: 11654 East 400 South (LaOtto, IN) - WATCH FOR AUCTION SIGNS!

INDUSTRIAL REAL ESTATE

11645 E. CR 400 S. -Noble Co. -Swan Twp.
Real Estate Offered @ 12:00 noon
Inspection Date: By Appointment



40,000 sq. ft. of building is currently being leased and generating ~\$14,000/mo.

Charleston Auctions
"International Industrial Auction Services"

Live Internet Bidding
BidSpotter.com
www.bidspotter.com
to register

BID LIVE ONLINE AT BIDSPOTTER.COM

Sale Location: 11654 East 400 South, LaOtto, IN 46763
Tuesday, March 31st Beginning @ 12:00 Noon Local Time
Preview Inspection: Tuesday, March 31st - 8:00 a.m. - 12:00 p.m.



Auctioneers: Robert Charleston, Chad Olson, Adam Olson, and EJ Olson.
Indiana Company License # AC68900001
1-260-373-0850 • Fax 1-260-373-0854

E-mail: info@charlestonauctions.com • Website: www.charlestonauctions.com





1976 VAN DORN 75 TON PLASTIC INJECTION PRESS



1979 VAN DORN 300 TON PLASTIC INJECTION PRESS



1984 VAN DORN 450 TON PLASTIC INJECTION PRESS



1985 VAN DORN 350 TON PLASTIC INJECTION PRESS



REED 300 TON PLASTIC INJECTION PRESS

PLASTIC INJECTION PRESSES & SUPPORT EQUIPMENT:

1986 CINCINNATI MILACRON 500 Ton Plastic Injection Machine, Model 500-32, 3 Phase, 460 Volt, 32 Oz. Shot Size, 33" x 33" Between Tie Bars, w/WHITLOCK Vacuum Loader, S/N 4025AZI/86-29

1984 VAN DORN 450 Ton Plastic Injection Machine, Model 450-RS-30F, CONAIR Vacuum Loader, 30" x 30" Between Tie Bars, S/N 750

1985 VAN DORN 350 Ton Plastic Injection Machine, Model 350-RS-30F, w/CONAIR Vacuum Loader, 27" x 27" Between Tie Bars, 3.75 Oz. Shot Size, S/N 1167

1979 VAN DORN 300 Ton Plastic Injection Machine, Model 300RS-3F, 24" x 24" Between Tie Bars, S/N 300RS-30F-1102

REED 300 Ton Plastic Injection Machine, Model 300TE, 21" x 21" Between Tie Bars, GE PM1000 Flo-Thru Controls, S/N P990961

1977 REED 200 Ton Plastic Injection Machine, Model 200TE, 17" x 17" Between Tie Bars, w/GE PM1000 Flo-Thru Controls, S/N P991408

REED 100 Ton Plastic Injection Machine, w/GE PM1000 Flo-Thru Controls & SCOREMAKER II Controller, 10 Second Machine Cycle, .65 Oz. Shot Size, 16" x 16" Between the Bars, TEMPTK LS Series H2O Temp Controller

1976 VAN DORN 75 Ton Plastic Injection Machine, Model 75-RS-5F, 16" x 16" Between Tie Bars, S/N 75-RS-5F-1214

(4) TEMPTK 7.5 HP Granulators, Model 1010EM, S/N's 4257-95, 4255-95, 3729-94, 3780-94

NOVATEC Vacuum Feeder, Model MD-25, S/N 3-3221-1052

Complete Water Chiller System, w/Softener, Piping, Pumps & Motors

(3) Plastic Process Vacuum Loaders, Model P161460, 3 Phase, 460 Volt, S/N's P161631791, P1616821092 & P161630791

(2) CONAIR Thermolators H2O Temperature Controllers

CONAIR FRANKLIN CD Carousel Dryer, Model D01A4000300000, 3 Phase, 480 Volt, S/N 2D1641

MACHINE SHOP EQUIPMENT:

1997 ATLAS COPCO Air Compressor, Model GA15, w/Elektronikon Controls, 20 HP, w/Air Receiver Tank, S/N H010044

VICTOR Lathe, Model 1640, 16" Swing, 40" BTC, 7.5 HP, 3 Phase, S/N 564563

KENT Hydraulic Surface Grinder, Model SGS-2040-AHD, 20" x 40" Electromagnetic Chuck, S/N 788001

LEBLOND Lathe, w/Speed Chuck, 1 1/2" Spindle Hole, 16" Swing, 40" BTC, S/N CL7110

HARDINGE Speed Lathe, Model DSM59, 1 HP, 3 Phase

ENERPAC H-Frame Shop Press, Model EB30GC, 30 Ton Capacity

6 x 18 Hand Feed Surface Grinder, Model 4001, 1 HP, S/N 7B-7380

BOYAR SHULTZ Hand Feed Surface Grinder, Model 618, 6" x 18" Magnetic Chuck, S/N 5-395

DELTRONIC DH214 Optical Comparator, 14" Capacity, S/N 249013466

INDEX Vertical Milling Machine, 9" x 42" T-Slot Table, 1 HP, Model 745, S/N 14346

JOHNSON Horizontal Band Saw, Model J, S/N 6396

KALAMAZOO Chop Saw, Model TRL-500, 440 Volt, 3 Phase, 3/4 HP, S/N 1506

Various Machine Vises, Cross Slide Rotary Tables, Collets, Surface Plates, Indexers & Radius Dressers

CINCINNATI No. 2 Tool Grinder

MATERIAL HANDLING EQUIPMENT:

HYSTER 8,000 Lb. Fork Truck, Model S80XL, Side Shift, 172" Lift Height, Hard Tire, 3-Stage, S/N D004V07627R

CLARK 4,000 Lb. Electric Pallet Mule, Model P40F, 24 Volt, S/N P465-0061-8113FB

MISCELLANEOUS EQUIPMENT:

SYSTEMS TECHNOLOGIES Industrial Finishing System, Natural Gas Fixed, Total Control Quick Panel Jr. Controls, Ansul Fire Suppression System, Pass Through Overhead Conveyor, Approximately 30' D x 16' W x 10' H

Huge Qty. Of New & Used Poly, Various Colors

TOOLTEX Assembly Machine

Various Floor Fans, Roll Around Safety Ladders, Pan Shelving, Wood Tables, Electrical, Salvage Equipment, Etc.

Various Office Equipment (I.E. Displays, Desks, Conference Tables & Chairs, Reception Area, Executive Furniture, Artwork, Computers, Monitors, Printers, Zebra Printer, Etc.)

Lg. Qty. Of In-Process Product (Primarily Automotive)

Lg. Qty. Of Q.C. Inspection Equipment, Perishable Tooling, Hand Tools, Fittings, Etc.

Hydraulic Lab Press w/Heated Platens

DAYMARC Winder, Model Type 149 Contractor, 220 Volt, 60 HZ, 3 Amp, S/N 149HT-G007

SYNTRON Vibratory Feeder, Model VM-50, S/N 456953

ROLLING STOCK:

2001 GMC ENVOY SLT, Loaded, Leather, Sun Roof, 4.2 Liter V-6 Vortec 4600 Engine, Vin. No. 1GKDT13502289887

1999 PLYMOUTH VOYAGER Mini Van, AM/FM Cassette, Air, Cruise, Vin. No. 2P4GP41G1XR442788

2002 BUICK LeSabre, Fully Loaded, Vin. No. 1G4HP52K044119087



REED 100 TON PLASTIC INJECTION PRESS



REED 200 TON PLASTIC INJECTION PRESS



ATLAS COPCO AIR COMPRESSOR & A.R.T.



**LEFT PIC: CLARK 4,000 LB. ELECTRIC PALLET MULE
RIGHT PIC: NOVATEC LOADER**



JOHNSON HORIZONTAL BAND SAW



**LEFT PIC: (6X18) HANDFEED SURFACE GRINDER
RIGHT PIC: CONAIR FRANKLIN VACUUM LOADER**



**LEFT PIC: DELTRONIC 14" OPTICAL COMPARITOR
RIGHT PIC: ENERPAC 30 TON H-FRAME PRESS**



**LEFT PIC: INDEX 1 HP VERTICAL MILLING MACHINE
RIGHT PIC: LINCOLN ARC WELDER**

IMPORTANT INFORMATION

PLEASE NOTE: OUR BIDDER PAYMENT TERMS AND CONDITIONS HAVE CHANGED. PLEASE VIEW OUR WEBSITE FOR DETAILS!

SALE LOCATION: 11654 East 400 South, LaOtto, IN 46763

DATE & TIME: The Auction will begin promptly at 12 Noon (Local) on Tuesday, March 31st.

Preview Inspection: The items will be available for advance inspection from 8:00 AM - 12:00 NOON (Local) on Tuesday, March 31st.

TERMS OF SALE: For on-site buyers a 12% Buyer's Premium will be charged on all purchases. A 15% Buyers' Premium will be charged if using a credit card. Charleston Auctions is now accepting all major credit cards. For On-Line Auction Terms, please visit bidspotter.com. All bidders must register and provide proper identification. All items are sold "as is, where is" and must be paid for IN FULL, in CASH, CHECK, OR CREDIT CARD accompanied by A LETTER FROM THE PAYOR'S BANK GUARANTEEING UNQUALIFIED PAYMENT TO CHARLESTON AUCTIONS for this sale.

REMOVAL: All rigging and moving companies must be pre-approved prior to sale day. No items will be removed without proof of payment. Sale day removal from conclusion of sale until 6 PM. Removal time will be March 31st from conclusion of auction until 6 p.m., and April 1st-4th, 8:30 a.m.-5 p.m. Lots not paid for and/or removed within the time allowed may be resold at public or private sale without further notice, and any deficiency, together with all expenses and charge of resale, will be charged to the defaulting purchaser. Your stamped paid receipt must be shown to checkout supervision prior to removal. **Although checkout supervision will be provided, the auction company and sellers are not liable for lost or stolen items purchased at the sale.**

DISCLAIMER AND ABSENCE OF WARRANTIES: Each potential Bidder is responsible to conduct, at their own risk and cost, their own independent inspections, investigations, inquiries, and due diligence concerning the property. Seller and Charleston, or Charleston's agents and associates, are not responsible for any warranty as to condition of property. Bidder shall be fully responsible for confirming that each item bid on is appropriate for Bidder's intended use. Neither Charleston nor Seller shall be responsible, in any way, for confirming or denying the specific identity or intended use of any item or piece of property. Inspection dates have been scheduled and will be staffed with auction personnel. Please feel free to inspect the property at any other time, so long as arranged in advance with Charleston. Bidder shall repair any damage to the Property done by Bidder, its representatives and agents, while conducting any Inspections. In addition, Bidder shall indemnify, defend and hold Seller harmless for any claims or damages suffered by Seller relating to actions taken by Bidder, its representatives and agents, while conducting any Inspections.

The property is being sold on AS IS, WHERE IS basis, and no warranty or representation, either express or implied, concerning the property is made by the Seller or the Auction Company. The information contained in this brochure is subject to verification by all parties relying on it. No liability for its accuracy, errors or omissions is assumed by the Sellers or the Auction Company.

GOVERNING LAW: Bidder agrees that no matter what State or Country Bidder resides, or location of the auction, all disputes or disagreements shall be construed according to the laws of the State of Indiana. **Charleston Auctions Reserves the right to reschedule due to inclement weather. Items Subject to Presale.**

INDUSTRIAL REAL ESTATE AUCTION

**11645 E. CR 400 S. -Noble Co. -Swan Twp.
Real Estate Offered @ 12:00 noon
Inspection Date: By Appointment**

Building Description:

Office Area 1,800 sq. ft.
Manuf./Warehouse Area 95,375 sq. ft.
Total Area SF 97,175 sq. ft.
Year Built 1984 to 2003
Foundation Concrete slab
Construction Type Metal
Ceiling Height 12'-24'
Heating/Cooling GFA/CA
Docks 6

Site Description:

Zoning IN-2 (General Industrial)
Acreage 7.44 acres
Access Public road
Parking Ample
Trailer Parking Yes



****40,000 sq. ft. of building is currently being leased and generating ~\$14,000/mo.****

Visit our web site for a complete listing of terms and conditions:
www.charlestonauctions.com