



433 Council Drive, Fort Wayne, IN 46825

**Plant Closing:  
CRAFT TOOL & MOLD, INC.**

**Sale Location:** 2720 Foundation Drive, South Bend, IN 46628

**WEDNESDAY, DECEMBER 6th - 10 A.M.** Local Time

Doors open at 8:00 AM on Sale Day

**Preview Inspection:** Tuesday, December 5th  
9:00 AM-5:00 PM

## DECEMBER

SUN	MON	TUE	WED	THU	FRI	SAT
					1	2
3	4	5	6	7	8	9
10	11	12	13	14	15	16
17	18	19	20	21	22	23
24	25	26	27	28	29	30
31	32					

**THINKING OF SELLING YOUR  
REAL ESTATE?**

*Consider the Auction Method!*

Call a Charleston rep. today for  
a confidential meeting.

**877-301-9344**

FIRST CLASS  
U.S. POSTAGE  
**PAID**  
FORT WAYNE, IN  
PERMIT #1420

# AUCTION



**Plant Closing:  
CRAFT TOOL & MOLD, INC.  
2720 FOUNDATION DRIVE, SOUTH BEND INDIANA 46628**

**WEDNESDAY, DECEMBER 6th • 10 AM LOCAL TIME**



1997 HURCO Vertical  
Machining Center

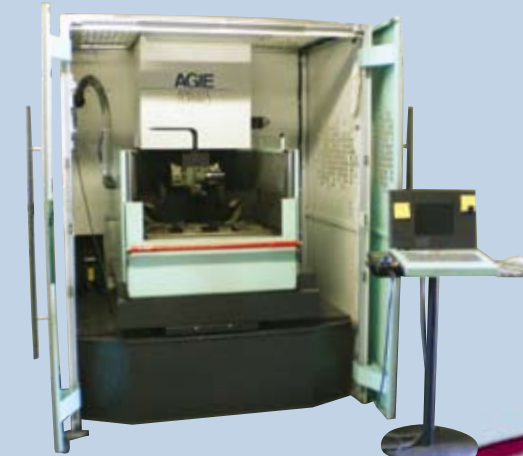

2002 AGIE Wire Electric  
Discharge Machine



HURCO CNC HAWK 5  
Vertical Milling Machine



HURCO CNC Vertical  
Milling Machine

**INDUSTRIAL  
AUCTION**  
COMPLETE TOOL & MOLD  
SHOP-DON'T MISS THIS  
OPPORTUNITY!

[WWW.CHARLESTONAUCTIONS.COM](http://WWW.CHARLESTONAUCTIONS.COM)

# AUCTION



**Plant Closing:  
CRAFT TOOL & MOLD, INC.  
2720 FOUNDATION DRIVE, SOUTH BEND, INDIANA 46628  
Sale Date: Wednesday, December 6th - 10 AM Local Time**

### MAP

### DRIVING DIRECTIONS

### UPCOMING AUCTIONS

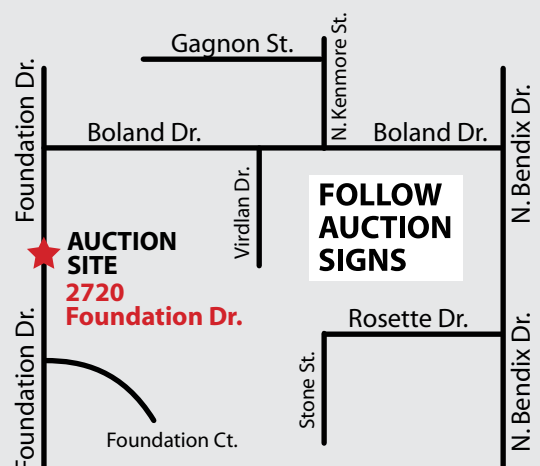

Hwy 80/90 Toll road to Hwy 31 South (Exit 72)  
Follow South Approximately 1 Mile to Hwy 20  
/ Lincoln Way West. Go East on Lincoln Way  
West to N. Bendix Drive, Turn Left. Follow N.  
Bendix Drive to Boland Drive, Turn Left. Follow to  
Foundation Drive, Turn Left ...  
**Follow Auction Signs.**

### HOTELS

**QUALITY INN**  
574-288-3800  
4124 Lincoln Way, West  
South Bend, IN 46628

**HOLIDAY INN EXPRESS**  
269-684-3900  
1265 South 11th Street  
Niles, MI

**SUPER 8 MOTELS**  
574-243-0200  
4124 Ameritech Drive  
South Bend, IN 46628

**SOUTH BEND REGIONAL AIRPORT**

### GENERAL ELECTRIC - TRANSFORMER DIVISION - AUCTION #2

FABRICATION EQUIPMENT  
Sale Date & Time: December 14th - 10:00 a.m. (Local Time)

**KENNEDY MANUFACTURING**  
DON'T MISS THE OPPORTUNITY TO BUY A  
KENNEDY TOOL BOX  
Sale Date & Time: December 12 - 10:00 a.m.  
(Local Time)

### GENERAL ELECTRIC COMPANY - MURFREESBORO, TN

PRESSES, WINDING EQUIPMENT, & MATERIAL  
HANDLING  
Sale Date & Time: February 2007 - 10:00 a.m. (Local Time)

### GENERAL ELECTRIC LIGHTING DIVISION - CLEVELAND, OH

LIGHT BULB MANUFACTURING EQUIPMENT &  
MATERIAL HANDLING EQUIPMENT  
Sale Date & Time: February 2007 - 10:00 a.m. (Local Time)

**Charleston Auctions**  
"International Industrial Auction Services"

Live Internet Bidding

**BidSpotter.com®**

[www.bidspotter.com](http://www.bidspotter.com)  
to register

**Sale Location:** 2720 Foundation Drive, South Bend Indiana 46628

**Wednesday, December 6th - 10 AM**

**Preview Inspection:** Tuesday, December 5th - 9:00 AM - 5:00 PM



**Auctioneers:** Robert Charleston AU01042047, Chad Olson AU10400029  
Company AC68900001

**1-260-373-0850 • Toll Free 1-877-301-9344**

**Fax 1-260-373-0854**

**E-mail:** [info@charlestonauctions.com](mailto:info@charlestonauctions.com) • **Website:** [www.charlestonauctions.com](http://www.charlestonauctions.com)





MITUTOYO Toolmakers Microscope



MSO O.D./I.D. Grinder



Lg. Qty. of Various Surface Grinders



AEG Tool Sharpener



ELOX Wire EDM



ELB Wet Type Surface Grinder



1998 DECKEL CNC Universal Milling Machine



LEFT PIC: MILLER Dialarc HF Welding Unit  
RIGHT PIC: HARIG Surface Grinder



(3 of 6) BRIDGEPORT Vertical Milling Machines



BROWN & SHARPE '818 Techmaster' Surface Grinder

**OFFSITE**  
SOLD ONLINE ONLY!

**CNC EQUIPMENT:**

1997 HURCO Vertical Machining Center, Model BMC 3017, 3-Phase, 24 Position Tool Changer, 16" x 24" T-Slot Table, HURCO Ultimax 3 Dual Screen Controller, S/N B3M91005077BC

HURCO CNC Vertical Milling Machine, Model HAWK5M, 13" x 42" T-Slot Table, HURCO Ultimax 3 Dual Screen Controls, 5 HP, 3-Phase, S/N KZL-9012095S

HURCO CNC Vertical Milling Machine, 12" x 42" T-Slot Table, 3-Phase, HURCO Ultimax Dual Screen Controls, S/N SDX-8005084A

1998 DECKEL CNC Universal Milling Machine, Model FP4A, HURCO Ultimax Dual Screen Controls, 21" x 35" T-Slot Table, S/N DHB8001098A

Over 50 Various 30 & 40 Tapper CNC Tool Holders

**ELECTRIC DISCHARGE MACHINES:**

2002 AGIE Wire Electric Discharge Machine, Model AGIECUT Classic 2S, AGIE Vision Control, Automatic Wire Feed, 55 Lb. Capacity, Submerged or Un-Submerged Operation, New AGIE HSS-C Generator, Patented "V" Wire Guiding System, TOROID Guide for 30 Degree Taper Production, Auto Reverse Skim Cutting, 5 GB HDP & CD ROM Technology, S/N 288

1985 ELOX Wire Electrical Discharge Machine, Model ELOX-FANUC Series P Wire Cut, Fanuc Controller, Electric Discharge Machine-540 Filter System, S/N C-5P0439

ELOX Sinker Electric Discharge Machine, Model 8-62, 3-Phase, Anilam DRO, Elox TCV-50 Controls, S/N 052786

ELOX Sinker Electric Discharge Machine, Model HRP-62, 3-Phase, Elox T50S Control, Anilam Wizard Z11 DRO, S/N 011831

**MILLING & DRILLING:**

(2) BRIDGEPORT Vertical Milling Machines, 2 HP, 9" x 42" T-Slot Table, SONY Millman DRO, S/N 266716 & 266699

BRIDGEPORT Vertical Milling Machine, 1 HP, 4" Column Riser, HEIDENHAIN Pos-E-Touch II DRO, 9" x 42" T-Slot Table

BRIDGEPORT Vertical Milling Machine, 1 HP, 9" x 42" T-Slot Table, HEIDENHAIN Pos-E-Touch II DRO, S/N 178348

BRIDGEPORT Vertical Milling Machine, 1 HP, 9" x 42" T-Slot Table, QMS 400 DRO, S/N 194833

MILWAUKEE Vertical Milling Machine, Model H, 9" x 46" T-Slot Table, 1088 Max. RPM, S/N 153197

BRIDGEPORT Vertical Milling Machine, 1 HP, HEIDENHAIN Pos-E-Touch II DRO, 9" x 42" T-Slot Table, S/N 57312

JET Bench-Top Drill Press, Model Jet-13R, 9" x 9" Rotary Table, 2800 RPM, S/N 40458

WESTHOFF Precision Horizontal Mill, Model 86-509, 8 1/2" x 8 1/2" Sliding Table, S/N 100-1

CLAUSING Variable Speed Drill Press, Model 22V1, 3-Phase, 1 1/2 HP, 15" x 18" T-Slot Table, S/N 504608

CINCINNATI Radial Arm Drill, 9" Column, 41" Arm, 20" x 24" T-Slot Table

1999 Variable Speed Drill Press, Model TV5-6, 7" x 7" Table Size, 6.5mm Capacity, S/N 87043

LASSY Tapper, Model 12-F, w/ Tooling

Lg. Qty. of Various Machine Tooling Consisting of: Advance Cross Slide Rotary Tables, Machine Vices, Set-Up Tooling Collets, Tie Downs, C-Clamps, Etc.

Lg. Qty. of Perishable Tooling To Include: Reamers, Carbide, Drills, End Mills, Tool Holders, Twist Drills, Etc.

GORTON Tracing Mill w/ Tooling & Templates, S/N 29

**GRINDING & BUFFING EQUIPMENT:**

BROWN & SHARPE '818 Techmaster' Surface Grinders, 8" x 18" Chuck, w/SONY Magnescale Readout, S/N 523-1818-1239

(2) CHEVALIER Surface Grinder, Model FSG 618M, 6" x 18" Magnetic Chuck, Lube System, S/N A3784045 & A3784044

HARIG Surface Grinder, Model 612 Ballway, 1 1/2 HP S/N B-19408

(4) HARIG Super 612 Surface Grinders, Model Super612, 6" x 12" Mag Chuck, S/N 12220, 11786, 6938 & 8898

MSO/AUSTIN O.D./I.D. Grinder, Model FM, 9" Capacity, Wet Type, Hydraulic, S/N 25099

ELB Wet Type Surface Grinder, Model SW4VAL, 8" x 16" Electro Magnetic, S/N 75700766

BOYER Schultz Surface Grinder, Model DE-LUXE, 6" x 12" Mag Chuck, 1 HP

AEG Tool Sharpener, Model ADEB63N2R3, 0.27 HP, Single Phase, S/N 26004873

DAREX End Mill Sharpener, Model E-85/90, 1/4 HP, 2800-3400 RPM, S/N E-85/90

Various Radius Dressers, Grinding Attachments, Index Heads, Etc.

Lg. Qty. Grinding Wheels (NEW & USED)

**LATHES:**

LEBLOND Lathe, 1 1/2" Spindle Hole, 15" Swing, BTC 28", S/N 6C966

SOUTH BEND Lathe, Model CL8145C, 6' Bed Length, Speed Chuck, 13" Swing, 1 1/2" Spindle Hole, S/N 4746TKLL3

Lg. Qty. Lathe Tooling: Face Plates, Chucks, Tool Post Holders, Tool Holders, Etc.

**SAWING MACHINES:**

ROLL-IN All Purpose Band Saw, 18 1/2" x 30 1/2" Sliding Table, 12" Throat, S/N 72037

RIKON Vertical Band Saw, Model RK14CS, 1 HP, Cutting Speeds-Low=1445 ft/m, High=2950 ft/m, 16" x 20" T-Slot Tilt Table, 13 1/2" Throat

**MATERIAL HANDLING:**

2000 YALE Electric 4,000 Lb. Fork Truck, Model ERP040, Mast-83/130, 36 Volt, Hydraulic Forks, Side Shift, S/N FE-7125

2000 Electric 5,000 Lb. Fork Truck, Model ERC050, Mast-84/171, Side Shift, 48 Volt, S/N FE-7383

2000 Electric 6,000 Lb. Fork Truck, Hydraulic Forks, Side Shift, 36 Volt, S/N FE-7131

CLARK 2,000 Lb. LP Fork Lift, Model CF20, 154" Lift Height, 2-Stage, Hard Tire, S/N CF-20-3-2113

**PLANT SERVICING/ MISCELLANEOUS EQUIPMENT:**

CHAMPION Vertical Air Compressor, Model VR5-8, Single Phase, 5 HP, S/N R15110465

EMGLO Horizontal Air Compressor, Model K15A-805, 1 1/2 HP, Single Phase, S/N A337862

DONALDSON Refrigerated Air Dryer, Model VF-50, Max Pressure-200, Max CFM-50, Single Phase, 115 Volt, S/N VICCMB1221

MILLER Dialarc HF Welding Unit, Model 901782, Single Phase, 60 HZ, 12.4 KW, 103/90/45 Amps, 200/230/460 Volts, S/N JJ349051

CAROLINA 30 Ton H-Frame Shop Press, Model HV100, S/N 004633

Various Banding Carts, Work Benches, Torch Sets, Storage Cabinets, Shop Stools & Hardware Cabinets

Various TORIT Dust Collection Systems

Various Pedestal & Bench Grinders

**ROLLING STOCK:**

2001 CHEVY 3/4 Ton 2500 Crew Cab, Loaded, Power Locks, Cruise, Air, Dual Airbags, Vortec V8 6.0 Liter Engine, 2-Wheel Drive, Very Clean, 138,000 Miles, Pendliner, VIN # 1GCHC29U31E194071

**QUALITY CONTROL/INSPECTION EQUIPMENT:**

MITUTOYO Toolmakers Micro Scope, Model TM-111, S/N 40950

SCHERR TUMICO 14" Optical Comparator, Model 22-0338, S/N 6682

Lg. Qty. of Various QC Equipment To Include: Surface Plates,

Calipers, Micrometers, Height Gages, Pin & Block Gage Sets, Sine Plates, Angle Plates, Etc.

LASER DESIGN INC. 3-D Laser, 10" x 16" Table, 6" Horz. Rotary Table

NUMEREX CORP. DNC Coordinate Measuring Machine, 48" x 30" x 18", PH9 Head, Optical Attachment

**OFFICE EQUIPMENT & FURNISHINGS:**

HP Design Jet 500 Plotter, Model C7770B, Digital Controls, S/N SG08E1101J

CANNON PC 921 Desktop Copier

Various Office Furnishings & Equipment To Include: Desks, Chairs, Tables, Bookshelves, White & Bulletin Boards, Refrigerators, Microwaves, Etc.



Various Late Model Electric Fork Lifts



LEFT PIC: DAREX End Mill Sharpener  
RIGHT PIC: Various BRIDGEPORT Milling Machines



LEBLOND Lathe



2001 CHEVY 3/4 Ton 2500 Crew Cab

**ON-LINE BIDDING INSTRUCTIONS**

- TO PARTICIPATE, YOU MUST:**
1. Type in www.bidspotter.com (make sure nothing is after .com)
  2. Find auction in upcoming auctions and click on sign up for this auction
  3. Left Side - click on New to bidspotter.com and then click on Register
  4. Fill out bidder registration
  5. Exit out and re-enter on www.bidspotter.com
  6. Click on Sign-up and then Sign In (already a bidspotter user)
  7. Utilize User Name & Password emailed to you after registering
  8. Exit out again and re-enter www.bidspotter.com
  9. Click on Bid Now
  10. START BIDDING!
  11. Bid with Bid Now Button for faster bidding

**ALL ON-LINE BIDS ARE SUBJECT TO A 13% BUYER'S PREMIUM, CASH OR CHECK. 16% BUYERS PREMIUM IF PAID BY MASTERCARD OR VISA**

**IMPORTANT INFORMATION**

**SALE LOCATION:** 2720 Foundation Drive, South Bend, Indiana 46628

**DATE & TIME:** The Auction will begin promptly at 10:00 AM (EST) on Wednesday, December 6th.

**PREVIEW INSPECTION:** The items will be available for advance inspection from 9:00 AM - 5:00 PM (EST) on Tuesday, December 5th.

**TERMS OF SALE:** A 10% Buyer's Premium will be charged on all purchases. A 13% Buyers' Premium will be charged if using MasterCard or Visa. For On-Line Auction Terms, please visit bidspotter.com. All bidders must register and provide proper identification. All items are sold "as is, where is" and must be paid for IN FULL, in CASH OR CHECK, accompanied by A LETTER FROM THE PAYOR'S BANK GUARANTEEING UNQUALIFIED PAYMENT TO CHARLESTON AUCTIONS for this sale.

**REMOVAL:** All rigging and moving companies must be pre-approved prior to sale day. No items will be removed without proof of payment. Sale day removal from conclusion of sale until 6 PM. **Removal times will be from 9:00 AM to 5:00 PM Local Time on November 7th & 8th.** Lots not paid for and/or removed within the time allowed may be resold at public or private sale without further notice, and any deficiency, together with all expenses and charge of resale, will be charged to the defaulting purchaser. Your stamped paid receipt must be shown to checkout supervision prior to removal. **Although checkout supervision will be provided, the auction company and sellers are not liable for lost or stolen items purchased at the sale.**

**NOTE:** While all information contained in this brochure and other advertising has been obtained from sources deemed reliable, neither the auction company, seller nor publisher shall be liable for any errors or for the correctness of descriptions. All purchases are made "as is, where is" based entirely on the personal inspection and/or opinion of the purchaser and without warranty or guarantee of any kind. Statements made sale day take precedence over printed matter. **Charleston Auctions Reserves the right to reschedule due to inclement weather.**